







Rear-mount switches



Base mount switches



IP66 handles with screw fixing

Padlockable handles		poles	Ie AC21	Two-screw fixing	Pack	Four-screw fixing 36x36 or 48x48*	Pack	Two-screw fixing	Pack
	Grey plate 67x67mm padlockable, black knob	3	20A	DS0203RRK6	1	DS0203PQK6S	1	DS0203BAK6	1
			32A	DS0323RRK6	1	DS0323PQK6S	1	DS0323BAK6	1
			40A	DS0403RRK6	1	DS0403PQK6S	1	DS0403BAK6	1
		3+N	20A	DS0204RRK6	1	DS0204PQK6S	1	DS0204BAK6	1
			32A	DS0324RRK6	1	DS0324PQK6S	1	DS0324BAK6	1
			40A	DS0404RRK6	1	DS0404PQK6S	1	DS0404BAK6	1
	Yellow plate 67x67mm padlockable, red knob	3	20A	DS0203RRL6	1	DS0203PQL6S	1	DS0203BAL6	1
			32A	DS0323RRL6	1	DS0323PQL6S	1	DS0323BAL6	1
			40A	DS0403RRL6	1	DS0403PQL6S	1	DS0403BAL6	1
		3+N	20A	DS0204RRL6	1	DS0204PQL6S	1	DS0204BAL6	1
			32A	DS0324RRL6	1	DS0324PQL6S	1	DS0324BAL6	1
			40A	DS0404RRL6	1	DS0404PQL6S	1	DS0404BAL6	1
	Grey plate 67x67 mm, black knob padlockable	3	20A	DS0203RQT6L	1	-	-	DS0203BAT6L	1
			32A	DS0323RQT6L	1	-	-	DS0323BAT6L	1
			40A	DS0403RQT6L	1	-	-	DS0403BAT6L	1
		3+N	20A	DS0204RQT6L	1	-	-	DS0204BAT6L	1
			32A	DS0324RQT6L	1	-	-	DS0324BAT6L	1
			40A	DS0404RQT6L	1	-	-	DS0404BAT6L	1
	Yellow plate 67x67 mm, red knob padlockable	3	20A	DS0203RQY6L	1	-	-	DS0203BAY6L	1
			32A	DS0323RQY6L	1	-	-	DS0323BAY6L	1
			40A	DS0403RQY6L	1	-	-	DS0403BAY6L	1
		3+N	20A	DS0204RQY6L	1	-	-	DS0204BAY6L	1
			32A	DS0324RQY6L	1	-	-	DS0324BAY6L	1
			40A	DS0404RQY6L	1	-	-	DS0404BAY6L	1
	Grey plate 48x48 mm, black knob padlockable Only for two-screw fixing	3	20A	DS0203RQT4L	1	-	-	DS0203BAT4L	1
			32A	DS0323RQT4L	1	-	-	DS0323BAT4L	1
			40A	DS0403RQT4L	1	-	-	DS0403BAT4L	1
		3+N	20A	DS0204RQT4L	1	-	-	DS0204BAT4L	1
			32A	DS0324RQT4L	1	-	-	DS0324BAT4L	1
			40A	DS0404RQT4L	1	-	-	DS0404BAT4L	1
	Yellow plate 48x48 mm, red knob padlockable Only for two-screw fixing	3	20A	DS0203RQY4L	1	-	-	DS0203BAY4L	1
			32A	DS0323RQY4L	1	-	-	DS0323BAY4L	1
			40A	DS0403RQY4L	1	-	-	DS0403BAY4L	1
		3+N	20A	DS0204RQY4L	1	-	-	DS0204BAY4L	1
			32A	DS0324RQY4L	1	-	-	DS0324BAY4L	1
			40A	DS0404RQY4L	1	-	-	DS0404BAY4L	1

Two-screw fixing, distance between holes: 28mm (1,10") Vertical or 32mm (1,26") Horizontal

Four-screw fixing, distance between holes: 48x48mm (1,89"x1,89")

* Fixing 48x48 (1,89"x1,89") with adapter flange (included in the package)

 standard article

Rear-mount switches



Base mount switches



■ IP66 handles with screw fixing

Non padlockable handles		poles	Ie AC21	Two-screw fixing	Pack	Four-screw fixing 36x36 or 48x48*	Pack	Four-screw fixing 36x36 or 48x48	Pack
	Grey plate 64x64 mm, black knob	3	20A	-	-	DS0203PQV6	1	DS0203BAV6	1
			32A	-	-	DS0323PQV6	1	DS0323BAV6	1
			40A	-	-	DS0403PQV6	1	DS0403BAV6	1
		3+N	20A	-	-	DS0204PQV6	1	DS0204BAV6	1
			32A	-	-	DS0324PQV6	1	DS0324BAV6	1
			40A	-	-	DS0404PQV6	1	DS0404BAV6	1
	Grey plate 48x48 mm, black knob Four-screw fixing at 36x36mm only	3	20A	-	-	DS0203PQV4	1	DS0203BAV4	1
			32A	-	-	DS0323PQV4	1	DS0323BAV4	1
			40A	-	-	DS0403PQV4	1	DS0403BAV4	1
		3+N	20A	-	-	DS0204PQV4	1	DS0204BAV4	1
			32A	-	-	DS0324PQV4	1	DS0324BAV4	1
			40A	-	-	DS0404PQV4	1	DS0404BAV4	1
	Yellow plate 64x64 mm, red knob	3	20A	-	-	DS0203PQW6	1	DS0203BAW6	1
			32A	-	-	DS0323PQW6	1	DS0323BAW6	1
			40A	-	-	DS0403PQW6	1	DS0403BAW6	1
		3+N	20A	-	-	DS0204PQW6	1	DS0204BAW6	1
			32A	-	-	DS0324PQW6	1	DS0324BAW6	1
			40A	-	-	DS0404PQW6	1	DS0404BAW6	1
	Yellow plate 48x48 mm, red knob Four-screw fixing at 36x36mm only	3	20A	-	-	DS0203PQW4	1	DS0203BAW4	1
			32A	-	-	DS0323PQW4	1	DS0323BAW4	1
			40A	-	-	DS0403PQW4	1	DS0403BAW4	1
		3+N	20A	-	-	DS0204PQW4	1	DS0204BAW4	1
			32A	-	-	DS0324PQW4	1	DS0324BAW4	1
			40A	-	-	DS0404PQW4	1	DS0404BAW4	1
Padlockable handles		poles	Ie AC21	Two-screw fixing	Pack	Four-screw fixing 36x36 or 48x48*	Pack	Four-screw fixing 36x36 or 48x48*	Pack
	Grey plate 67x67mm padlockable, black knob	3	20A	-	-	-	-	DS0203BAK6S	1
			32A	-	-	-	-	DS0323BAK6S	1
			40A	-	-	-	-	DS0403BAK6S	1
		3+N	20A	-	-	-	-	DS0204BAK6S	1
			32A	-	-	-	-	DS0324BAK6S	1
			40A	-	-	-	-	DS0404BAK6S	1
	Yellow plate 67x67mm padlockable, red knob	3	20A	-	-	-	-	DS0203BAL6S	1
			32A	-	-	-	-	DS0323BAL6S	1
			40A	-	-	-	-	DS0403BAL6S	1
		3+N	20A	-	-	-	-	DS0204BAL6S	1
			32A	-	-	-	-	DS0324BAL6S	1
			40A	-	-	-	-	DS0404BAL6S	1

Two-screw fixing, distance between holes: 28mm (1.10") Vertical or 32mm (1.26") Horizontal

Four-screw fixing, distance between holes: 48x48mm (1.89"x1.89")

* Fixing 48x48 (1.89"x1.89") with adapter flange (included in the package)

standard article





Rear-mount switches



Base mount switches



■ IP66 handles with screw fixing

Non padlockable handles		poles	Ie AC21	Two-screw fixing	Pack	Four-screw fixing 36x36 or 48x48	Pack	Two-screw fixing	Pack
	Grey plate 67x67 mm, black knob	3	20A	DS0203RQT6	1	-	-	DS0203BAT6	1
			32A	DS0323RQT6	1	-	-	DS0323BAT6	1
			40A	DS0403RQT6	1	-	-	DS0403BAT6	1
		3+N	20A	DS0204RQT6	1	-	-	DS0204BAT6	1
			32A	DS0324RQT6	1	-	-	DS0324BAT6	1
			40A	DS0404RQT6	1	-	-	DS0404BAT6	1
	Yellow plate 67x67 mm, red knob	3	20A	DS0203RQY6	1	-	-	DS0203BAY6	1
			32A	DS0323RQY6	1	-	-	DS0323BAY6	1
			40A	DS0403RQY6	1	-	-	DS0403BAY6	1
		3+N	20A	DS0204RQY6	1	-	-	DS0204BAY6	1
			32A	DS0324RQY6	1	-	-	DS0324BAY6	1
			40A	DS0404RQY6	1	-	-	DS0404BAY6	1
	Grey plate 48x48 mm, black knob Only for two-screw fixing	3	20A	DS0203RQT4	1	-	-	DS0203BAT4	1
			32A	DS0323RQT4	1	-	-	DS0323BAT4	1
			40A	DS0403RQT4	1	-	-	DS0403BAT4	1
		3+N	20A	DS0204RQT4	1	-	-	DS0204BAT4	1
			32A	DS0324RQT4	1	-	-	DS0324BAT4	1
			40A	DS0404RQT4	1	-	-	DS0404BAT4	1
	Yellow plate 48x48 mm, red knob Only for two-screw fixing	3	20A	DS0203RQY4	1	-	-	DS0203BAY4	1
			32A	DS0323RQY4	1	-	-	DS0323BAY4	1
			40A	DS0403RQY4	1	-	-	DS0403BAY4	1
		3+N	20A	DS0204RQY4	1	-	-	DS0204BAY4	1
			32A	DS0324RQY4	1	-	-	DS0324BAY4	1
			40A	DS0404RQY4	1	-	-	DS0404BAY4	1

Two-screw fixing, distance between holes: 28mm (1.10") Vertical or 32mm (1.26") Horizontal

Rear mount switches



Base mount switches



■ IP66 handles with Ø22mm (0,87") single-hole and nut fixing

Padlockable handles		poles	Ie AC21	Ø22mm (0,87") single-hole and nut fixing	Pack	Ø22mm (0,87") single-hole and nut fixing	Pack
	Grey plate 67x67mm padlockable, black knob	3	20A	DS0203GDK6	1	DS0203BFK6	1
			32A	DS0323GDK6	1	DS0323BFK6	1
			40A	DS0403GDK6	1	DS0403BFK6	1
		3+N	20A	DS0204GDK6	1	DS0204BFK6	1
			32A	DS0324GDK6	1	DS0324BFK6	1
			40A	DS0404GDK6	1	DS0404BFK6	1
	Yellow plate 67x67mm padlockable, red knob	3	20A	DS0203GDL6	1	DS0203BFL6	1
			32A	DS0323GDL6	1	DS0323BFL6	1
			40A	DS0403GDL6	1	DS0403BFL6	1
		3+N	20A	DS0204GDL6	1	DS0204BFL6	1
			32A	DS0324GDL6	1	DS0324BFL6	1
			40A	DS0404GDL6	1	DS0404BFL6	1
	Grey plate 67x67 mm, black knob padlockable	3	20A	DS0203GDT6L	1	DS0203BFT6L	1
			32A	DS0323GDT6L	1	DS0323BFT6L	1
			40A	DS0403GDT6L	1	DS0403BFT6L	1
		3+N	20A	DS0204GDT6L	1	DS0204BFT6L	1
			32A	DS0324GDT6L	1	DS0324BFT6L	1
			40A	DS0404GDT6L	1	DS0404BFT6L	1
	Yellow plate 67x67 mm, red knob padlockable	3	20A	DS0203GDY6L	1	DS0203BFY6L	1
			32A	DS0323GDY6L	1	DS0323BFY6L	1
			40A	DS0403GDY6L	1	DS0403BFY6L	1
		3+N	20A	DS0204GDY6L	1	DS0204BFY6L	1
			32A	DS0324GDY6L	1	DS0324BFY6L	1
			40A	DS0404GDY6L	1	DS0404BFY6L	1
	Grey plate 48x48 mm, black knob padlockable	3	20A	DS0203GDT4L	1	DS0203BFT4L	1
			32A	DS0323GDT4L	1	DS0323BFT4L	1
			40A	DS0403GDT4L	1	DS0403BFT4L	1
		3+N	20A	DS0204GDT4L	1	DS0204BFT4L	1
			32A	DS0324GDT4L	1	DS0324BFT4L	1
			40A	DS0404GDT4L	1	DS0404BFT4L	1
	Yellow plate 48x48 mm, red knob padlockable	3	20A	DS0203GDY4L	1	DS0203BFY4L	1
			32A	DS0323GDY4L	1	DS0323BFY4L	1
			40A	DS0403GDY4L	1	DS0403BFY4L	1
		3+N	20A	DS0204GDY4L	1	DS0204BFY4L	1
			32A	DS0324GDY4L	1	DS0324BFY4L	1
			40A	DS0404GDY4L	1	DS0404BFY4L	1

standard article





Rear mount switches



Base mount switches



■ IP66 handles with Ø22mm (0,87") single-hole and nut fixing

Non padlockable handles		poles	Ie AC21	Ø22mm (0,87") single-hole and nut fixing	Pack	Ø22mm (0,87") single-hole and nut fixing	Pack
 <p>Grey plate 67x67 mm, black knob</p>	3	20A	DS0203GDT6	1	DS0203BFT6	1	
		32A	DS0323GDT6	1	DS0323BFT6	1	
		40A	DS0403GDT6	1	DS0403BFT6	1	
	3+N	20A	DS0204GDT6	1	DS0204BFT6	1	
		32A	DS0324GDT6	1	DS0324BFT6	1	
		40A	DS0404GDT6	1	DS0404BFT6	1	
 <p>Yellow plate 67x67 mm, red knob</p>	3	20A	DS0203GDY6	1	DS0203BFY6	1	
		32A	DS0323GDY6	1	DS0323BFY6	1	
		40A	DS0403GDY6	1	DS0403BFY6	1	
	3+N	20A	DS0204GDY6	1	DS0204BFY6	1	
		32A	DS0324GDY6	1	DS0324BFY6	1	
		40A	DS0404GDY6	1	DS0404BFY6	1	
 <p>Grey plate 48x48 mm, black knob</p>	3	20A	DS0203GDT4	1	DS0203BFT4	1	
		32A	DS0323GDT4	1	DS0323BFT4	1	
		40A	DS0403GDT4	1	DS0403BFT4	1	
	3+N	20A	DS0204GDT4	1	DS0204BFT4	1	
		32A	DS0324GDT4	1	DS0324BFT4	1	
		40A	DS0404GDT4	1	DS0404BFT4	1	
 <p>Yellow plate 48x48 mm, red knob</p>	3	20A	DS0203GDY4	1	DS0203BFY4	1	
		32A	DS0323GDY4	1	DS0323BFY4	1	
		40A	DS0403GDY4	1	DS0403BFY4	1	
	3+N	20A	DS0204GDY4	1	DS0204BFY4	1	
		32A	DS0324GDY4	1	DS0324BFY4	1	
		40A	DS0404GDY4	1	DS0404BFY4	1	





Rear mount switches



Base mount switches



■ IP66 handles with Ø22mm (0,87") single-hole and nut fixing

Non padlockable handles		poles	Ie AC21	Ø22mm (0,87") single-hole and nut fixing	Pack	Ø22mm (0,87") single-hole and nut fixing	Pack
	Grey plate 64x64 mm, black knob	3	20A	DS0203GDV6	1	DS0203BFV6	1
			32A	DS0323GDV6	1	DS0323BFV6	1
			40A	DS0403GDV6	1	DS0403BFV6	1
		3+N	20A	DS0204GDV6	1	DS0204BFV6	1
			32A	DS0324GDV6	1	DS0324BFV6	1
			40A	DS0404GDV6	1	DS0404BFV6	1
	Grey plate 48x48 mm, black knob	3	20A	DS0203GDV4	1	DS0203BFV4	1
			32A	DS0323GDV4	1	DS0323BFV4	1
			40A	DS0403GDV4	1	DS0403BFV4	1
		3+N	20A	DS0204GDV4	1	DS0204BFV4	1
			32A	DS0324GDV4	1	DS0324BFV4	1
			40A	DS0404GDV4	1	DS0404BFV4	1
	Yellow plate 64x64 mm, red knob	3	20A	DS0203GDW6	1	DS0203BFW6	1
			32A	DS0323GDW6	1	DS0323BFW6	1
			40A	DS0403GDW6	1	DS0403BFW6	1
		3+N	20A	DS0204GDW6	1	DS0204BFW6	1
			32A	DS0324GDW6	1	DS0324BFW6	1
			40A	DS0404GDW6	1	DS0404BFW6	1
	Yellow plate 48x48 mm, red knob	3	20A	DS0203GDW4	1	DS0203BFW4	1
			32A	DS0323GDW4	1	DS0323BFW4	1
			40A	DS0403GDW4	1	DS0403BFW4	1
		3+N	20A	DS0204GDW4	1	DS0204BFW4	1
			32A	DS0324GDW4	1	DS0324BFW4	1
			40A	DS0404GDW4	1	DS0404BFW4	1

Base mounting



Direct operation
Black knob



For standard cabinets
45mm (1.77") slots
Black knob

Rear mounting



2 screw fixing
at 28mm
vertical distance



4 screw fixing
36x36mm (1.42"x1.42")
or 48x48mm (1.89"x1.89")



∅ 22mm (∅ 0.87")
single hole
and nut fixing

Direct operation

poles	Ie AC21	Code	Pack	Code	Pack	Code	Pack	Code	Pack	Code	Pack
3 pole	20A	DS0203BFCD	1	DS0203BDDN	1	DS0203R	1	DS0203P	1	DS0203G	1
	32A	DS0323BFCD	1	DS0323BDDN	1	DS0323R	1	DS0323P	1	DS0323G	1
	40A	DS0403BFCD	1	DS0403BDDN	1	DS0403R	1	DS0403P	1	DS0403G	1
4 pole	20A	DS0204BFCD	1	DS0204BDDN	1	DS0204R	1	DS0204P	1	DS0204G	1
	32A	DS0324BFCD	1	DS0324BDDN	1	DS0324R	1	DS0324P	1	DS0324G	1
	40A	DS0404BFCD	1	DS0404BDDN	1	DS0404R	1	DS0404P	1	DS0404G	1

Accessories and spare parts





Additional poles

Code	Description	Pack
DSC040PAR	DS020/040 4th pole early make/late break (for Neutral) rear mounting	5
DSC040PSR	DS020/040 4th pole rear mounting	5
DSC040PAB	DS020/040 4th pole early make/late break (for Neutral) base mounting	5
DSC040PSB	DS020/040 4th pole base mounting	5
DSC040PENR	DS020/040 4th pole poleEN rear mounting	5
DSC040PENB	DS020/040 4th pole poleEN base mounting	5
DSC040NOR	DS020/040 auxiliary contact NO rear mounting	5
DSC040NOB	DS020/040 auxiliary contact NO base mounting	5
DSC040NCR	DS020/040 auxiliary contact NC rear mounting	5
DSC040NCB	DS020/040 auxiliary contact NC base mounting	5

Accessories and spare parts

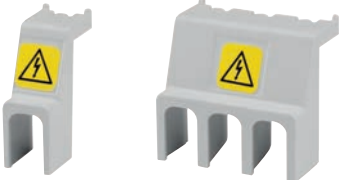
	Code	Description	Pack
 <p>Padlockable plate for DS_FCD</p>	DS040PAD	DS020/040 Transparent Padlockable plate for DS_FC	5

	Code	Description	Pack
 <p>Terminal covers</p>	DS040PR1	DS020/040 Pair of one-pole terminal covers	5
	DS040PR3	DS020/040 Pair of three-pole terminal covers	5

	Code	Description	Pack
 <p>Shafts</p>	PALBL300	Shaft L=300mm Q5	5
	PALBL500	Shaft L=500mm Q5	5
	PALBL055	Shaft L=55mm Q5	5
	PALBL075	Shaft L=75mm Q5	5
	PALBL095	Shaft L=95mm Q5	5
	PALBL115	Shaft L=115mm Q5	5
	PALBL135	Shaft L=135mm Q5	5
	PALBL155	Shaft L=155mm Q5	5
	PALBL175	Shaft L=175mm Q5	5

 standard article

■ Rear mounting

Measures in mm (in)

2 holes with screws

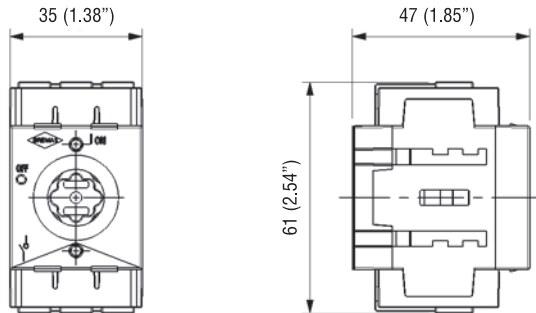

Drilling templates

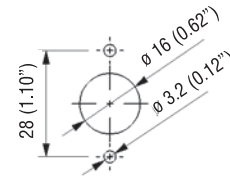

Two-screws fixing

4 holes with screws

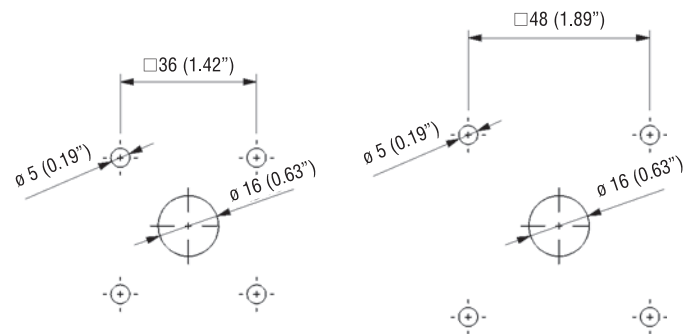
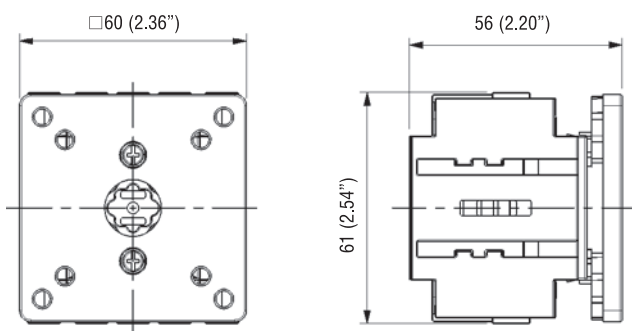

Four-screws fixing

Ø 22mm (0,87") single hole with locking nut

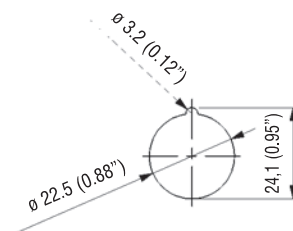
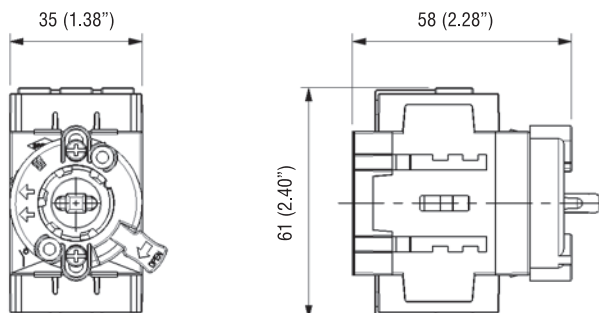

Handles fixing with
Ø 22mm (0,87") single hole
and locking nut

Base mounting

Measures in mm (in)

Screw-fixed handles

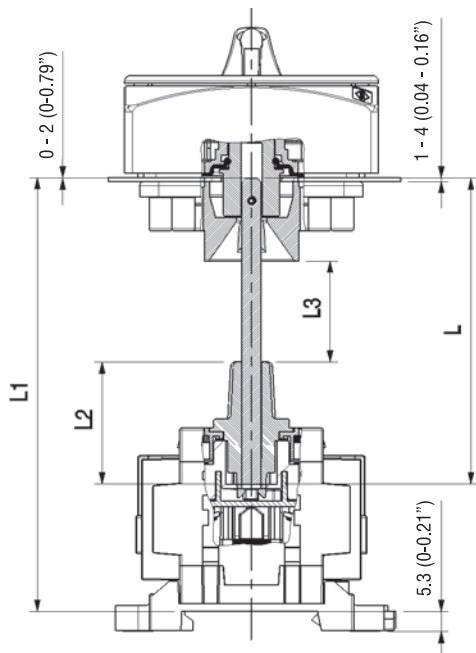

Cutting length of the extension shaft

The base mounting execution is provided with integrated control knob and includes the housing for the shaft and the fixing screw. The depth of insertion of the shaft in the housing has a tolerance of about 20mm, this allows to reduce the need and the precision of the cutting to size (dimension L) of the shaft.

To determine the cut length L of the shaft, consider the following guidelines:

$L3 \geq 1\text{mm}$
 $12\text{mm} \leq L2 \leq 32\text{mm}$

In practice: $L1 - 53\text{mm} \leq L \leq L1 - 33\text{mm}$

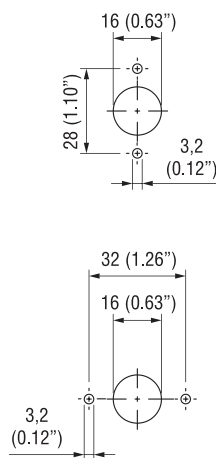

Two-screw handle fixing

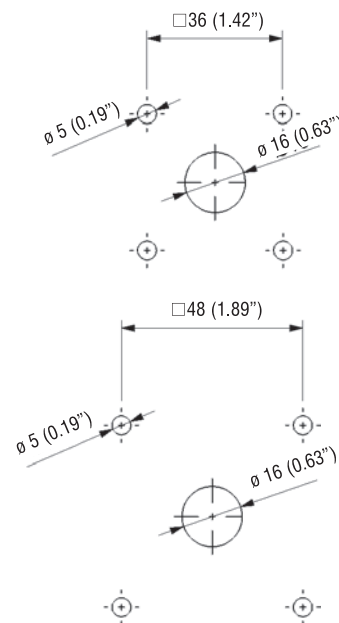

Four-screw handle fixing

Ø 22mm (0,87") single-hole handle fixing

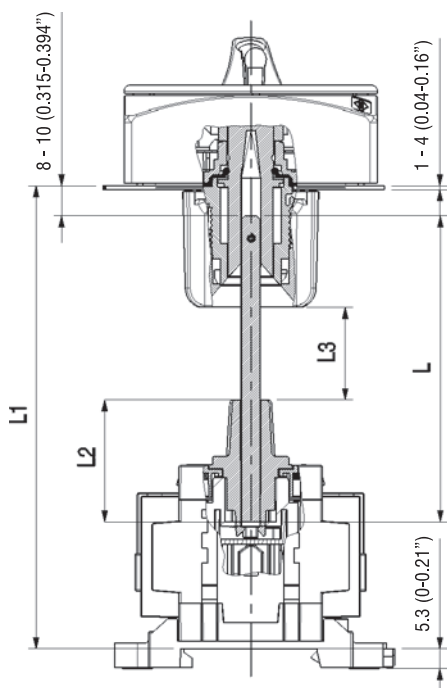

To determine the cut length L of the shaft, consider the following guidelines:

$L3 \geq 1\text{mm}$
 $12\text{mm} \leq L2 \leq 32\text{mm}$

In practice: $L1 - 61\text{mm} \leq L \leq L1 - 41\text{mm}$

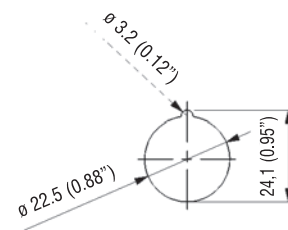

Ø 22mm (0,87") single-hole handle fixing

■ Base mounting

Measures in mm (in)

Direct command

Drilling templates - Base mount

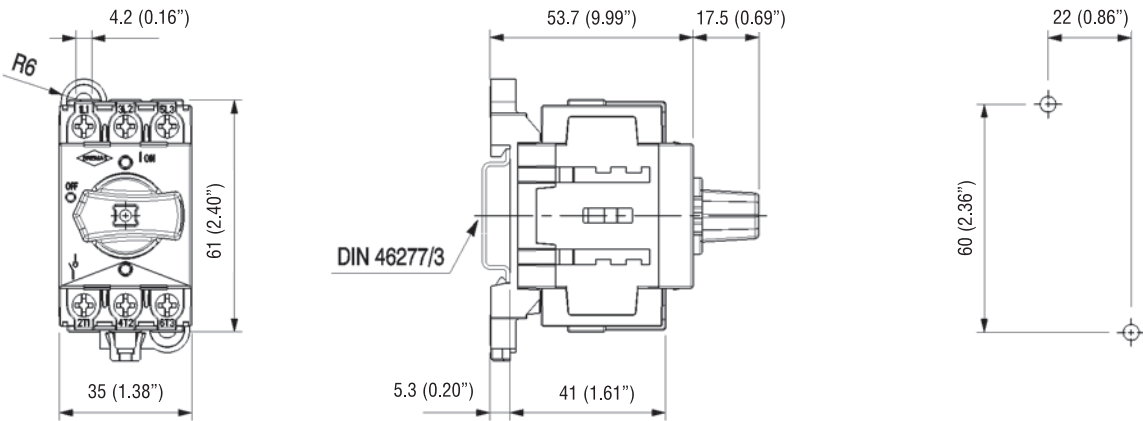

DDN version - For panel board

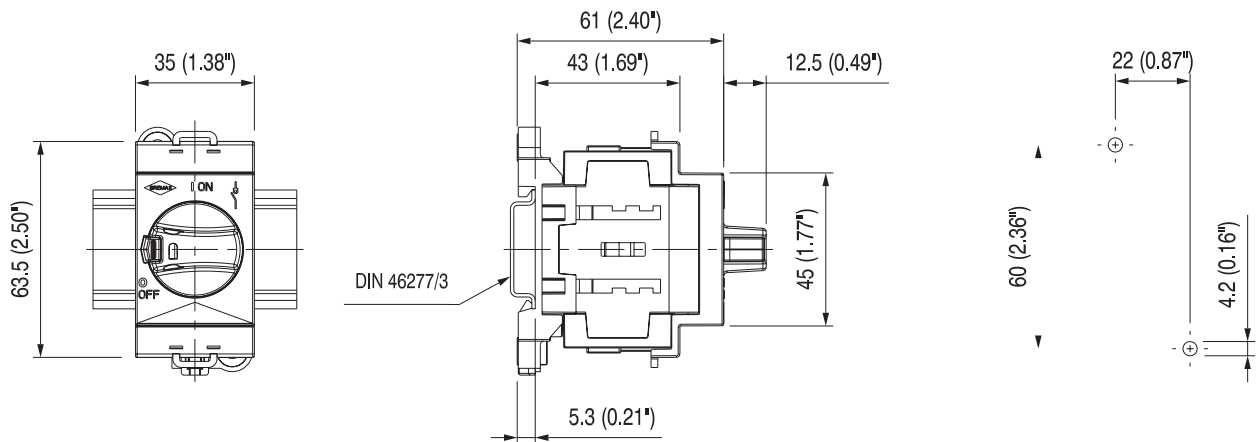

Fourth pole (additional/auxiliary)

